

REV.	ECN NO.	MODIFIED MARK	APPROVED
A		FIRST RELEASE	

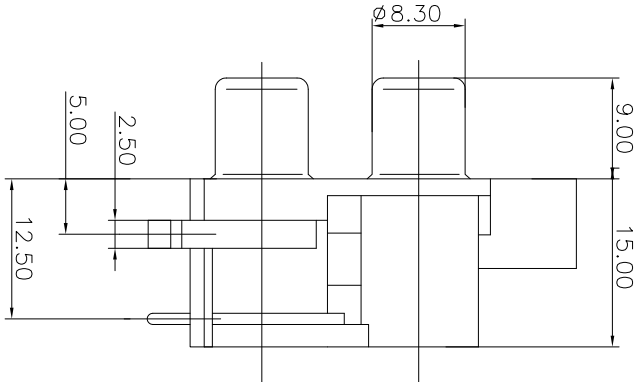

NOTES:
 ELECTRICAL:
 1:RATED CURRENT: 0.2A Max.
 2:RATED VOLTAGE: 50V AC.
 3:CONTACT RESISTANCE: 30 MILLIOHMS Max.
 AFTER TESTING:100 MILLIOHMS Max.
 4:INSULATION RESISTANCE: 100 MEGAOHMS Min.
 5:IELECTRIC WITHSTANDING VOLTAGE: 500 VAC Min.
 MECHANICAL:
 1:INSERTION FORCE: 3N-30N.
 2:WITHDRAWAL FORCE: 3N-30N.
 3:DURABILITY: 100 CYCLES.
 ENVIRONMENTAL:
 TEMPERATURE RANGE: -20°C TO 60°C.

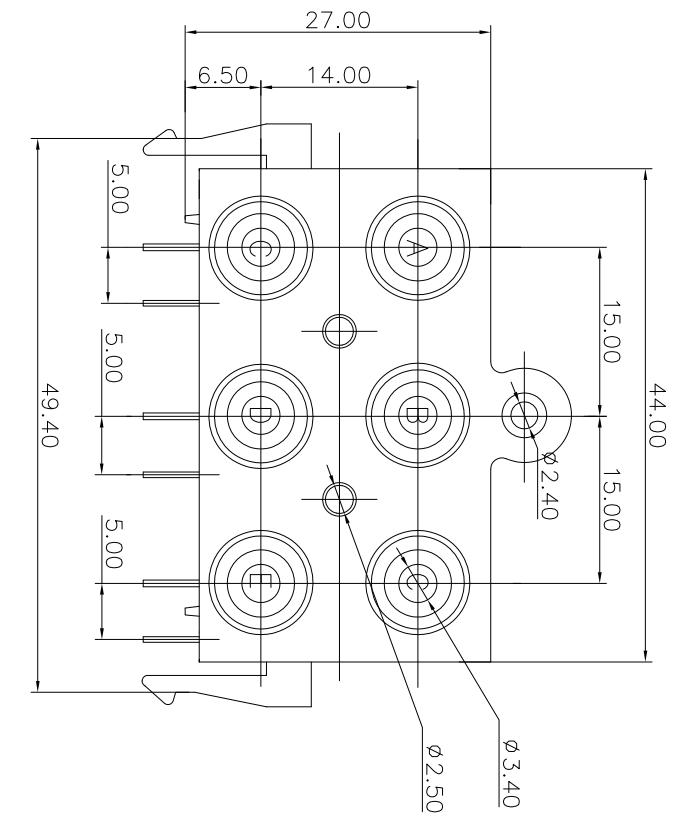
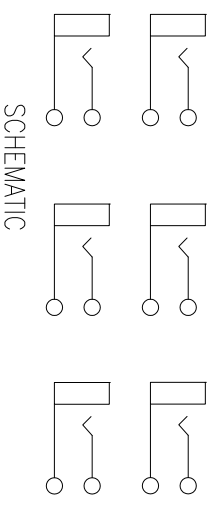
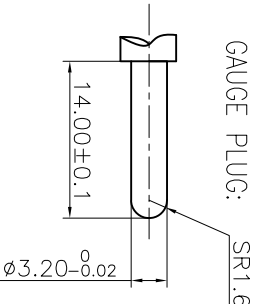

PCB LAYOUT
TOP VIEW

ANGLE	±5°	MODEL NAME: RCA-619	 广东正宝科技有限公司 GUANGDONG TREMPRO TECHNOLOGY CO., LTD.
63 < L	±0.5	(PART NO.)	
16 < L ≤ 63	±0.4	DESIGN: X.H.Wang 11/24'18	TITLE: RCA PIN JACK
4 < L ≤ 16	±0.3	CHECKED: L.W.Wu 11/24'18	DWG NO.:
L ≤ 4	±0.2	MAT'L: See table	UNIT: mm
TOL TABLE:		FINISH: See table	VIEW:
THIS DOCUMENT IS THE PROPERTY OF TREMPRO TECHNOLOGY CO., LTD.NO PART THEREOF MAY BE REPRODUCED AND USED WITHOUT THE PRIOR WRITTEN CONSENT OF THE OWNER		Q'TY./:	SCALE: 5:1
		APPROVED: X.Q.Hu 11/24'18	SHEET: 1/1
			SIZE: A3
			REV.: A