

PCB LAYOUT  
TOP VIEW

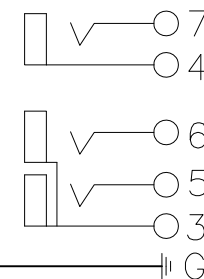

SCHEMATIC

NOTES:  
ELECTRICAL:  
1:RATED CURRENT: 0.2A Max.  
2:RATED VOLTAGE: 50V AC.  
3:CONTACT RESISTANCE: 30 MILLIOHMS Max.  
AFTER TESTING:100 MILLIOHMS Max.  
4:INSULATION RESISTANCE: 100 MEGAOHMS Min.  
5:DIELECTRIC WITHSTANDING VOLTAGE: 500 VAC Min.  
MECHANICAL:  
1:INSERTION FORCE: 3N-30N.  
2:WITHDRAWAL FORCE: 3N-30N.  
3:DURRABILITY: 100 CYCLES.  
ENVIRONMENTAL:  
TEMPERATURE RANGE: -20°C TO 60°C.

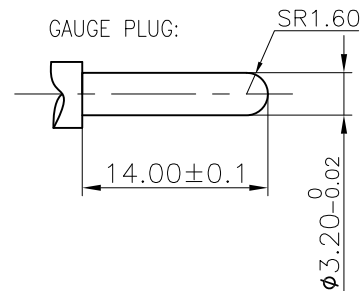

ANGLE	±5°
63 < L	±0.5
16 < L ≤ 63	±0.4
4 < L ≤ 16	±0.3
L ≤ 4	±0.2
TOL TABLE:	
THIS DOCUMENT IS THE PROPERTY OF ZHENGWEI ELECTRONICS CO.,LTD. NO PART THEREOF MAY BE REPRODUCED AND USED WITHOUT THE PRIOR WRITTEN CONSENT OF THE OWNER	

MODEL NAME: RCA-313A  
(PART NO.)

MAT'L:  
See table

FINISH:  
See table

Q'TY: /

DESIGN: Z.F.Lian 09/07'18

CHECKED: L.W.Wu 09/07'18

APPROVED: X.Q.Hu 09/07'18



广东正宝科技有限公司  
GUANGDONG TRENPRO TECHNOLOGY CO. LTD.

TITLE: RCA PIN JACK

DWG NO.:

UNIT: mm

VIEW:

SCALE: 5:1

SHEET: 1/1

SIZE: A3

REV.: A